

# Illustrated Index

## Transmission Housing

---

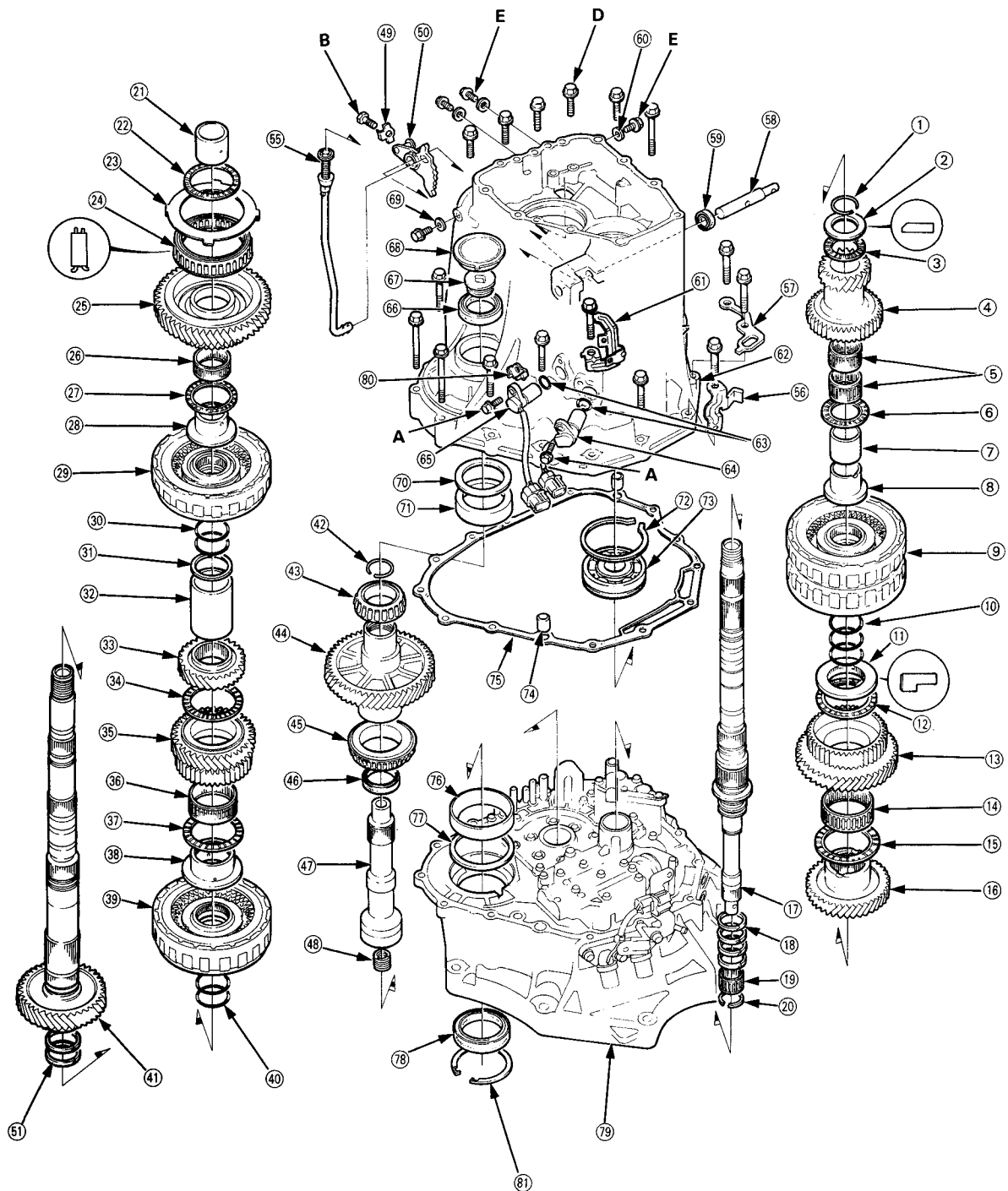



- ① SNAP RING
- ② THRUST WASHER
- ③ THRUST NEEDLE BEARING
- ④ MAINSHAFT 1ST GEAR
- ⑤ NEEDLE BEARINGS
- ⑥ THRUST NEEDLE BEARING
- ⑦ MAINSHAFT 1ST GEAR DISTANCE COLLAR
- ⑧ MAINSHAFT 1ST GEAR COLLAR
- ⑨ 1ST/4TH CLUTCH ASSEMBLY
- ⑩ O-RING Replace.
- ⑪ THRUST WASHER. 43 x 74 mm Selective part
- ⑫ THRUST NEEDLE BEARING
- ⑬ MAINSHAFT 4TH GEAR
- ⑭ NEEDLE BEARING
- ⑮ THRUST NEEDLE BEARING
- ⑯ MAINSHAFT 3RD GEAR
- ⑰ MAINSHAFT
- ⑱ SEALING RINGS. 37 mm
- ⑲ NEEDLE BEARING
- ⑳ SET RING
- ㉑ COUNTERSHAFT 2ND GEAR COLLAR
- ㉒ THRUST NEEDLE BEARING
- ㉓ SET PLATE
- ㉔ 1ST GEAR ONE-WAY CLUTCH
- ㉕ COUNTERSHAFT 1ST GEAR
- ㉖ NEEDLE BEARING
- ㉗ THRUST NEEDLE BEARING
- ㉘ COUNTERSHAFT 1ST GEAR COLLAR
- ㉙ 1ST-HOLD CLUTCH ASSEMBLY
- ㉚ O-RING Replace.
- ㉛ THRUST WASHER. 38.8 x 47 mm Selective part
- ㉜ 1ST-HOLD CLUTCH DISTANCE COLLAR
- ㉝ COUNTERSHAFT 4TH GEAR
- ㉞ THRUST NEEDLE BEARING
- ㉟ COUNTERSHAFT 3RD GEAR
- ㊱ NEEDLE BEARING
- ㊲ THRUST NEEDLE BEARING
- ㊳ COUNTERSHAFT 3RD GEAR COLLAR
- ㊴ 3RD CLUTCH ASSEMBLY
- ㊵ O-RING Replace.
- ㊶ COUNTERSHAFT
- ㊷ SET RING Replace.
- ㊸ TAPERED ROLLER BEARING
- ㊹ SECONDARY GEAR SHAFT
- ㊺ TAPERED ROLLER BEARING
- ㊻ SECONDARY GEAR SHAFT OIL SEAL Replace.
- ㊼ EXTENSION SHAFT
- ㊽ SECONDARY SPRING
- ㊾ LOCK WASHER Replace.
- ㊿ DETENT LEVER
- ① SEALING RINGS. 42 mm
- ② PARKING BRAKE ROD
- ③ HARNESS STAY
- ④ TRANSMISSION HANGER
- ⑤ CONTROL SHAFT
- ⑥ OIL SEAL Replace.
- ⑦ SEALING WASHER Replace.
- ⑧ SPEED SENSOR CONNECTOR STAY
- ⑨ TRANSMISSION HOUSING
- ⑩ O-RINGS Replace.
- ⑪ MAINSHAFT SPEED SENSOR
- ⑫ COUNTERSHAFT SPEED SENSOR
- ⑬ TRANSMISSION HOUSING OIL SEAL Replace.
- ⑭ SEALING BOLT
- ⑮ SECONDARY COVER
- ⑯ SEALING WASHER Replace.
- ⑰ THRUST WASHER, 75 mm Selective part
- ⑱ BEARING OUTER RACE
- ⑲ SNAP RING
- ㉑ TRANSMISSION HOUSING MAINSHAFT BEARING
- ㉒ DOWEL PIN
- ㉓ TRANSMISSION HOUSING GASKET Replace.
- ㉔ BEARING OUTER RACE
- ㉕ WASHER
- ㉖ TORQUE CONVERTER HOUSING OIL SEAL Replace.
- ㉗ TORQUE CONVERTER HOUSING
- ㉘ COUNTERSHAFT SPEED SENSOR WASHER
- ㉙ SNAP RING

## TORQUE SPECIFICATIONS

No.	Torque Value	Bolt Size	Remarks
A	12 N·m (1.2 kg-m, 9 lb-ft)	6 x 1.0 mm	
B	14 N·m (1.4 kg-m, 10 lb-ft)	6 x 1.0 mm	Special Bolt
D	34 N·m (3.4 kg-m, 26 lb-ft)	8 x 1.25 mm	
E	18 N·m (1.8 kg-m, 13 lb-ft)	8 x 1.25 mm	Oil Pressure Check Bolt